



8 Hillside, Agden Brow, Lymm, WA13 0UD
£210,000



8 Hillside, Agden Brow, Lymm, WA13 0UD

£210,000

Amazing accommodation in a semi rural location with views over farmland. This spacious park home is situated on one of the best plots comprising hallway, dining room open to spacious lounge with windows to three sides, modern kitchen with views over farmland from the sink unit and utility room. Two double bedrooms one with ensuite and a further shower room. Externally there is parking and gardens to all sides. A VIEWING IS A MUST TO APPRECIATE THE SPACE AND LOCATION. Over 50's only.

Description



Council Tax Band: A

Floor Plans

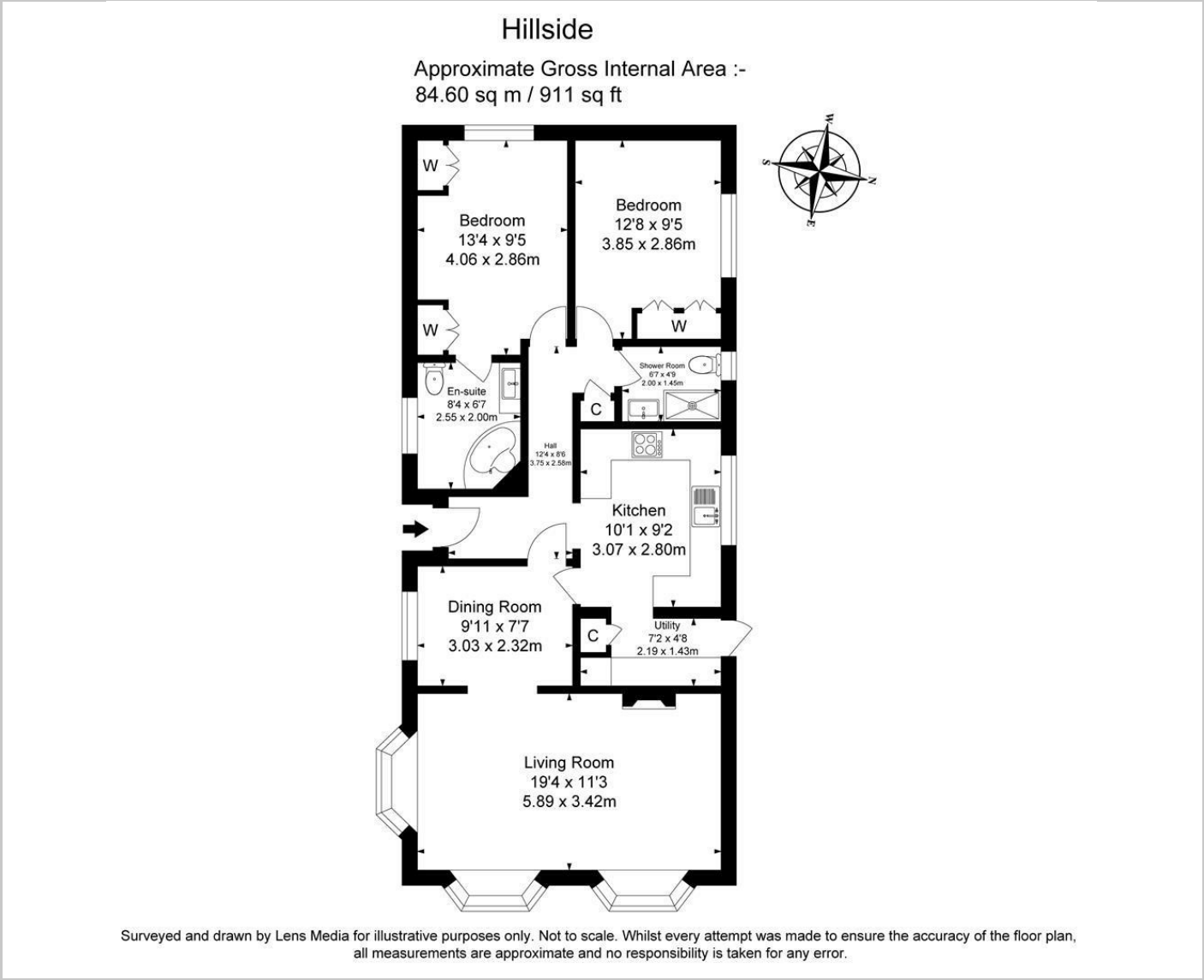

Area Map

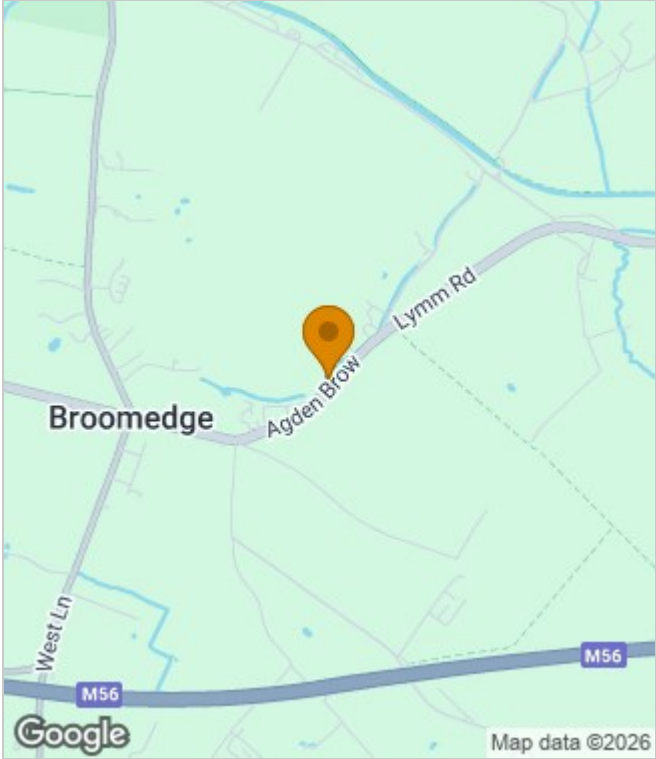

Energy Performance Graph

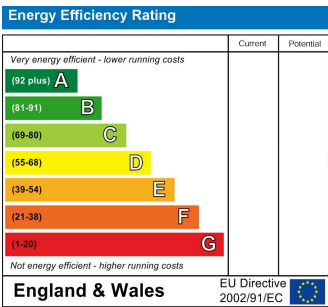

These particulars, whilst believed to be accurate are set out as a general outline only for guidance and do not constitute any part of an offer or contract. Intending purchasers should not rely on them as statements of representation of fact, but must satisfy themselves by inspection or otherwise as to their accuracy. No person in this firms employment has the authority to make or give any representation or warranty in respect of the property.